

NOTES:
RESPONSIBILITY IS NOT ACCEPTED FOR ERRORS MADE BY OTHERS IN SCALING FROM THIS DRAWING. THIS DRAWING IS COPYRIGHT OF GLENN HOWELLS ARCHITECTS.

GLENN HOWELLS ARCHITECTS LTD, TAKE NO RESPONSIBILITY FOR THE ELECTRONIC INFORMATION USED TO CREATE THIS DRAWING THAT HAS BEEN GENERATED BY A THIRD PARTY, AND THE RESPONSIBILITY OF WHICH REMAINS WITH THE ORIGINATOR. INFORMATION SHOWN FOR COORDINATION PURPOSES ONLY.

GLENN HOWELLS ARCHITECTS TAKE NO RESPONSIBILITY FOR THE LOCATION OF LEGAL BOUNDARIES INDICATED ON THIS DRAWING AND ADVISE A SEPARATE DRAWING BE COMPLETED BY A SPECIALIST SURVEYOR TO ESTABLISH EXACT BOUNDARIES.

KEY

— Planning Application Boundary



Date	Rev	By	Details
28.03.22	P01	IS	Planning

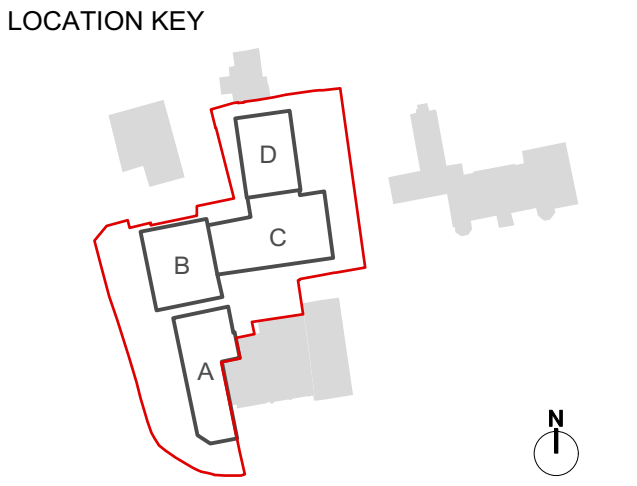

For Planning

Glenn Howells Architects
Middlesex House, 34-42 Cleveland Street, London, W1T 4JE
glennhowells.co.uk

Project
The Roundway
Haringey

Client
Hillview (London) LLP

Drawing Title
GA Plans
Proposed Third Floor Plan

Date	Scale	Drawn by	Checked
10.03.22	1:200@A1 1:400@A3	IS	DH
Project Ref.	Drawing No.	Revision	
2242	2242-GHA-ZZ-00-DR-A-(05)103	P01	